

Pop Up S10

– as Curved and Straight version

Unique Selling Points

- ✓ **Winner of “Best of the Best” Red Dot Design Award**
- ✓ Magnetic assembly – means no more broken hooks or hangars
- ✓ New generation of Pop Up utilizing stronger yet lighter materials

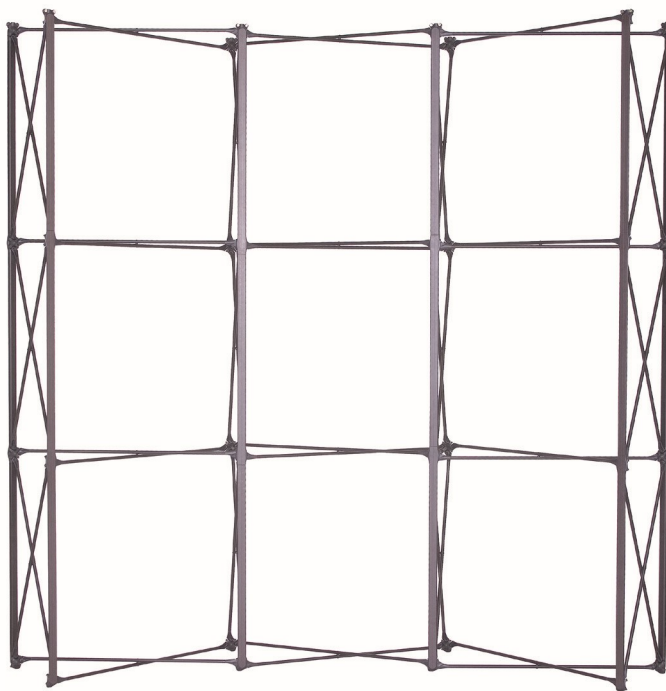

reddot design award
best of the best 2008

Pop Up S10

A wonder wall of great design.

NO DOUBT, THE POP UP S10 is our most interesting new product, setting a new standard for Pop Up systems. Uncompromising design meets the most user friendly solution on the market today. We have carefully selected materials that meet the highest demands and a new smart magnetic system provides for quick and easy assembly.



All locks and hooks have been replaced with innovative super magnetic solutions.



A complete Pop Up S10, including accessories, easily fits in a transport case on wheels.



reddot design award
best of the best 2008



Available in different widths and as curved or straight structures. The height is 225cm.



The graphic panels easily attach to the foldable magnetic bars.

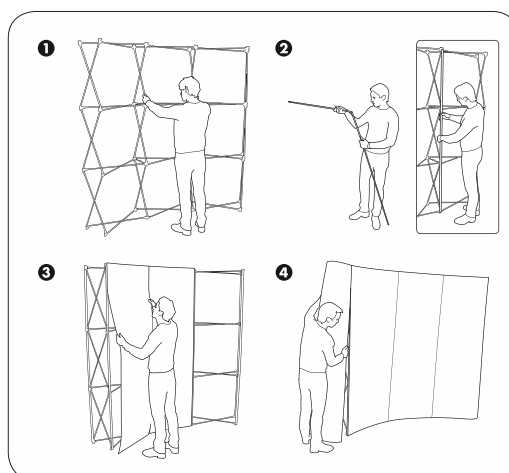

Pop Up S10 | SET UP INSTRUCTION

1

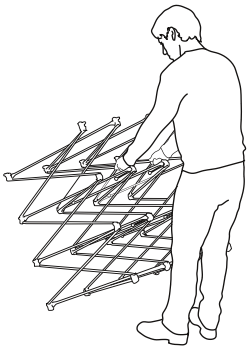

2

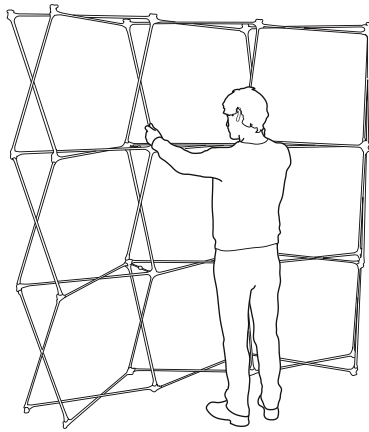

3

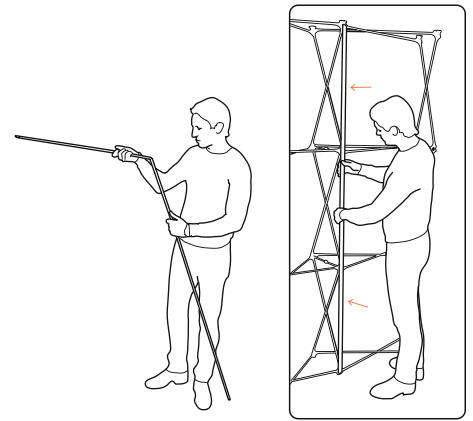

4

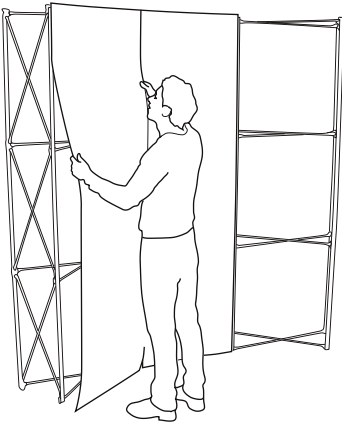

5

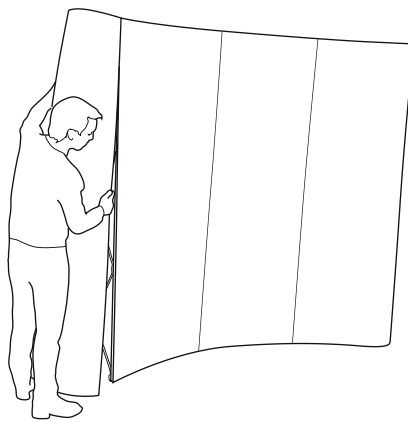

6

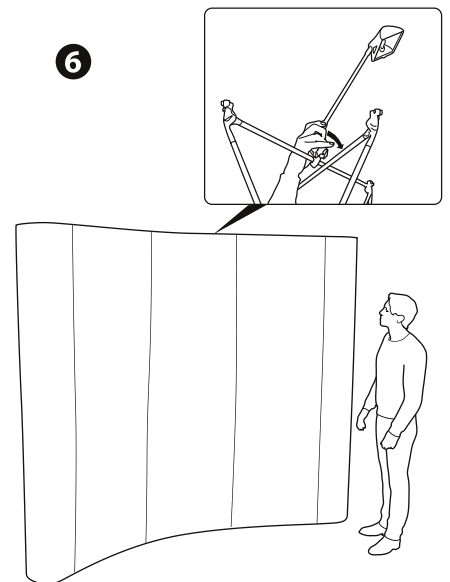

Pop Up S10 | PANEL IDENTIFICATION

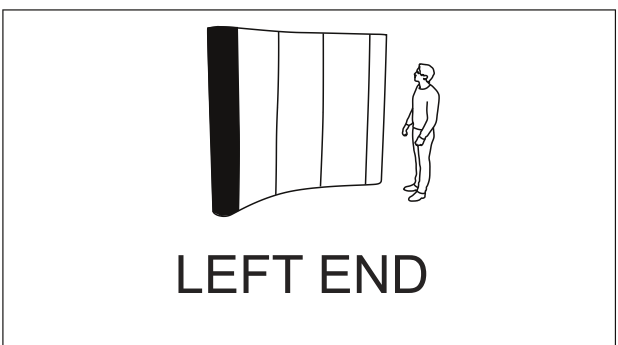
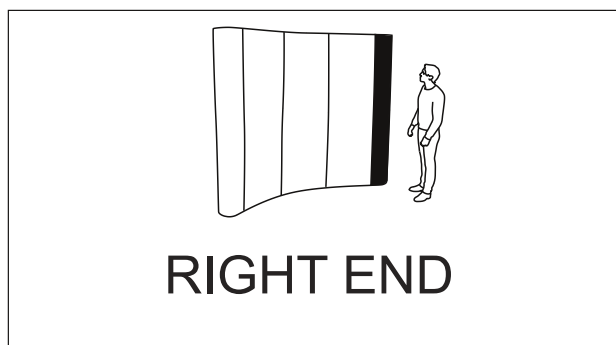
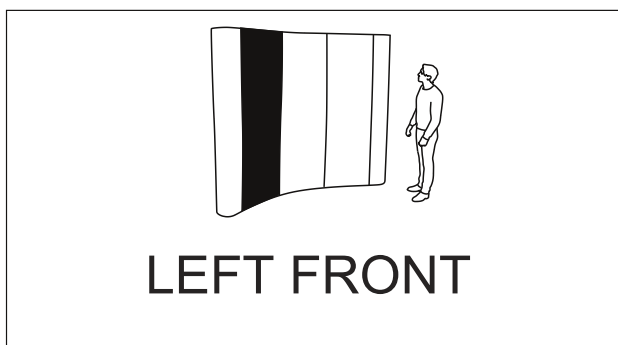
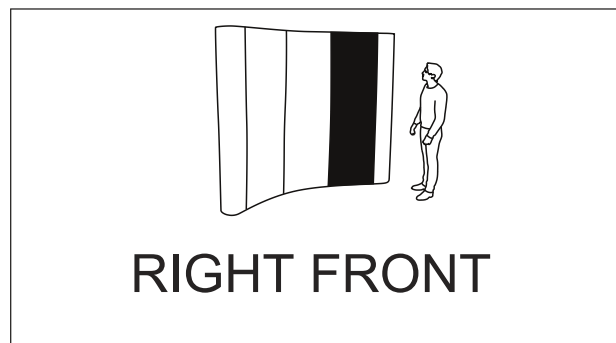
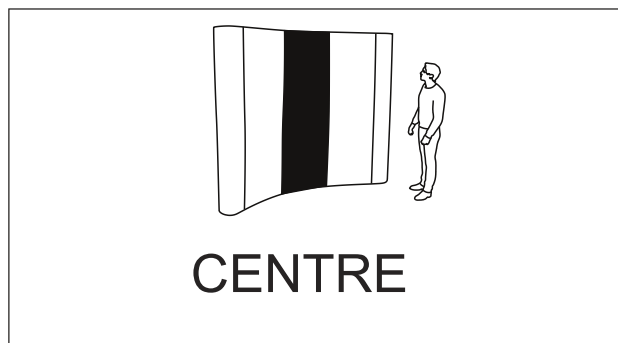

Pop Up S10, Straight | DIMENSIONS

Pop Up S10, Straight - 1x3

1 (+1) Straight Panel (73.3 x 225.0 cm)
2 Side Panels (67.0 x 225.0 cm)

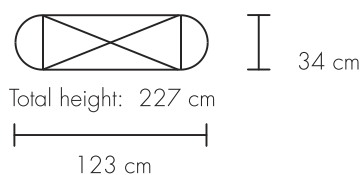

Pop Up S10, Straight - 3x3

3 (+3) Straight Panels (73.3 x 225.0 cm)
2 Side Panels (67.0 x 225.0 cm)

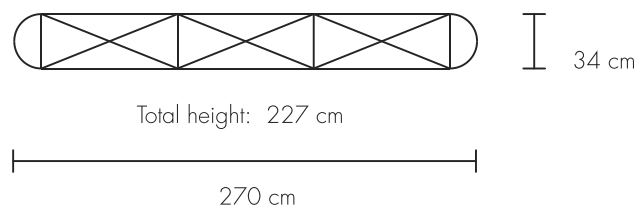

Pop Up S10, Straight - 2x3

2 (+2) Straight Panels (73.3 x 225.0 cm)
2 Side Panels (67.0 x 225.0 cm)

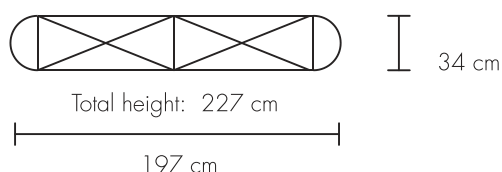

Pop Up S10, Straight - 4x3

4 (+4) Straight Panels (73.3 x 225.0 cm)
2 Side Panels (67.0 x 225.0 cm)

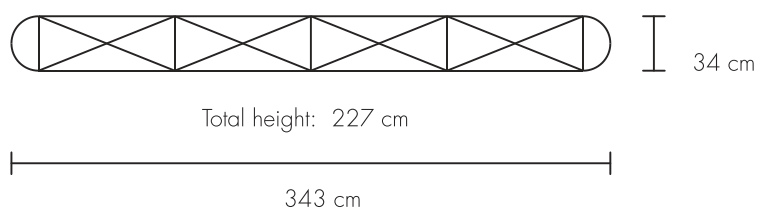

Pop Up S10, Straight - 5x3

5 (+5) Straight Panels (73.3 x 225.0 cm)
2 Side Panels (67.0 x 225.0 cm)

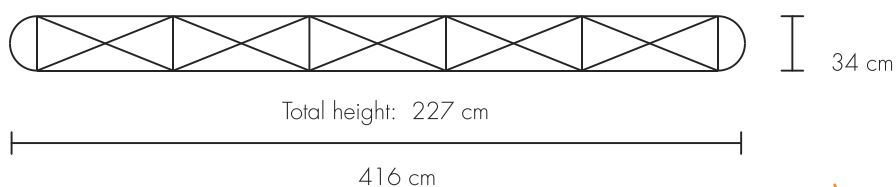

Pop Up S10

Version (4x3 Straight)

Dimensions	73.3x225cm x4 + 67x225cm x2
Available versions	Curved: 1x3, 2x3, 3x3, 4x3, 5x3 Straight: 1x3, 2x3, 3x3, 4x3 , 5x3
Assembly	Magnetic locks, tapes, and guides. (No tools required)

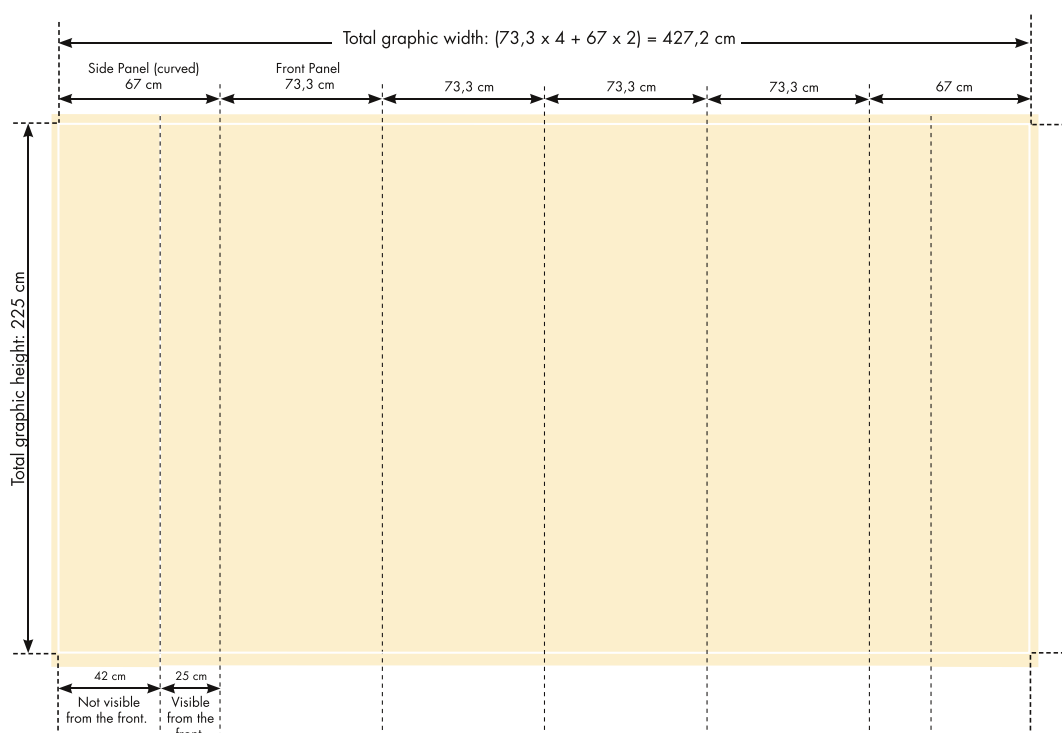

Assembly Instruction

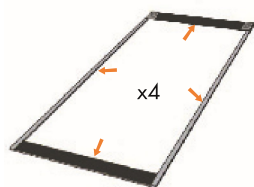

Front panels: Start by mounting the supplied top and bottom strips to the back of the graphic panels according to the image above. Then carefully mount the magnetic tape along the sides of the panels.

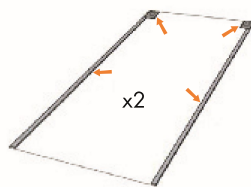

Side panels: Mount the corner strips to the top corners of the side panels according to the image above. Carefully mount the magnetic tape as in the previous step.

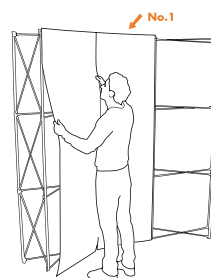

Mount the front panel first by starting with the top corners. Then guide the graphic panel towards the bottom by centering it on the magnetic bars.

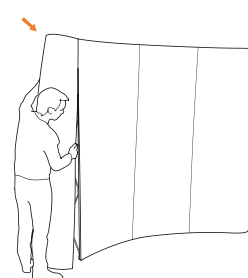

The side panels are attached last in the same way as the front panels. Manually curve the panels to make them easier to attach.